



Product Specifications

(SLIM II LED FLOOD LIGHT)



The Slim II LED Flood Light is a compact and powerful lighting solution designed for industrial and commercial applications. Built with an optimized die-casting aluminum housing, it offers superior thermal management, ensuring long-lasting performance. With professional light distribution and multiple beam angles, the Slim II adapts to various lighting needs.

The clear tempered glass cover enhances durability, minimizing the risk of damage in tough environments, while the top-branded LEDs and power supply guarantee reliability and a lifespan of over 50,000 hours. The Slim II LED Flood Light also boasts IK08 high mechanical impact resistance, IP66 waterproof protection, and is designed for easy transportation due to its compact size. With a 5-year warranty, this flood light delivers excellent performance and durability in even the most demanding settings.

Features

- Optimized die-casting aluminum housing design for superior thermal management;
- Professional light distribution with different beam angles for various applications;
- Clear tempered glass cover decrease risk of lamp breaking for strong industrial applications;
- Packed with top branded LEDs and power supply to ensure the product reliability and life expectancy;
- High mechanical impact resistance and ingress protection, IP66 structural waterproof design;
- Compact in size and easy for transportation;
- Long life time over 50,000 hours, 5 years warranty.

Technical Specifications

Model No.	LGS-FL-TG3B-4	LGS-FL-TG3B-5	LGS-FL-TG3B-6	LGS-FL-TG3B-7	LGS-FL-TG3B-8	LGS-FL-TG3B-9	LGS-FL-TG3B-10
Power	50W	80W	100W	150W	200W	240W	300W
Lumen Output	7,500lm	12,000lm	15,000lm	22,500lm	30,000lm	36,000lm	45,000lm
Lumen Efficiency	150lm/w						
CCT	3000/4000/5000/5700/6500K						
CRI	Ra>70(Ra>80/90 on request)						
Chip Brand	Lumileds/Seoul						
Beam Angle $\theta/2$	25/60/90/120/T2/T3/T4						
Light Decay Rate	Less than 3% in 6,000Hours						
Lifespan	$\geq 50,000$ Hrs						
Input Voltage	100-240VAC 50/60Hz						
Power Factor	PF>0.95						
THD	<15%						
Driver Brand	Meanwell/Philips/Sosen						
Material	Die-cast Aluminum Housing+Polycarbonate Lens+Tempered Glass Cover Die-cast Aluminum Housing+Tempered Glass Cover(for 120 degree)						
Degree of Protection	IP66						
Dimensions(mm)	217*312*52	343*369*56	343*369*56	368*412*58	393*422*58	439*484*67	439*484*67
Net Weight	1.7kg	4.1kg	4.2kg	5.6kg	6.9kg	8.5kg	8.7kg
Finish	Black						
Installation	Mounting						
Working Temperature	$-30^{\circ}\text{C}\sim+50^{\circ}\text{C}$						
Storage Temperature	$-40^{\circ}\text{C}\sim+70^{\circ}\text{C}$						
Certificate	CE, RoHS						
Warranty	5 years						
Optional Functions	0-10V/PWM/DALI/DMX Available on Request						

Structure

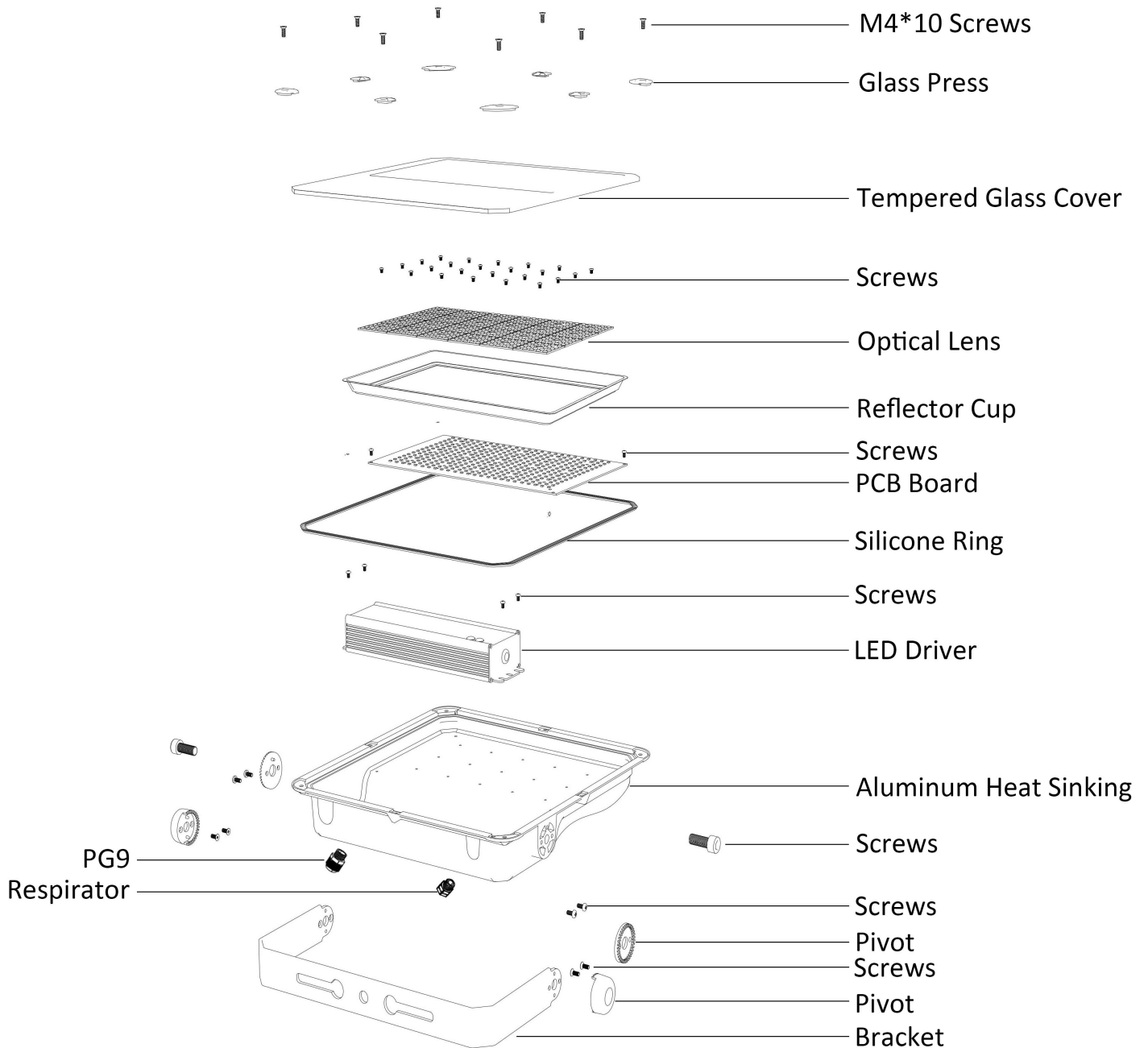

Dimensions

Unit: mm

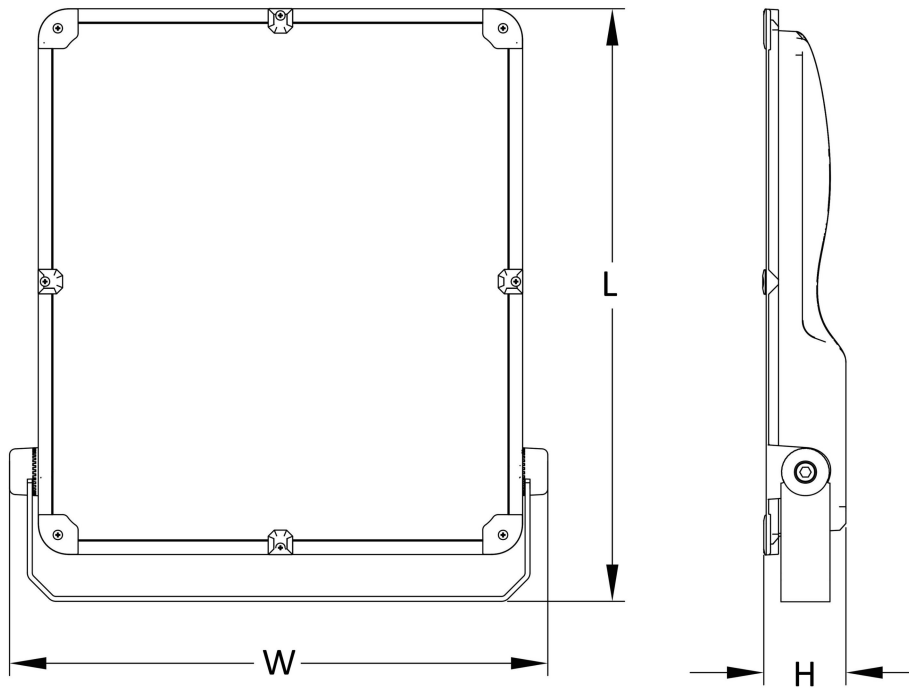

Model No.	L	W	H
LGS-FL-TG3B-4	312	217	52
LGS-FL-TG3B-5	369	343	56
LGS-FL-TG3B-6	369	343	56
LGS-FL-TG3B-7	412	368	58
LGS-FL-TG3B-8	422	393	58
LGS-FL-TG3B-9	484	439	67
LGS-FL-TG3B-10	484	439	67

Installation Requirements

1. Power off before installation, and read the instruction carefully;
2. Make sure the installation material can endure the lamp weight;
3. Please prepare two sets of expansion bolts, and drill holes in the installation body, then install the lamp, finally screw down expansion bolts and bracket screws;
4. Connect lamp wire to match power wire, and seal the joint with insulation;
5. The lamp must be installed reliably to prevent loosening and falling off.

Notice

1. Please first read the product specification carefully, make sure the using environment conform to specification, then it can be used;
2. Please confirm the input voltage, frequency before use;
3. This product must be installed by professionals;
4. If there is any damage to the power wire or shell of the product, it should be taken as defective product and do not use;
5. Dangerous high voltage, non-professionals are not allowed to maintain the product;
6. If external soft cable or soft wire of the light is damaged, it should be replaced by manufacturer or service agent or personnel with similar qualification to avoid danger.

Applications

Widely used for shopping center, exhibition hall, parking lot, stadium, gymnasium, billboard, park, statue, government lighting decoration project, landmark or building, pubic square and passage, building connecting passage, and other indoor or outdoor light applications.

