

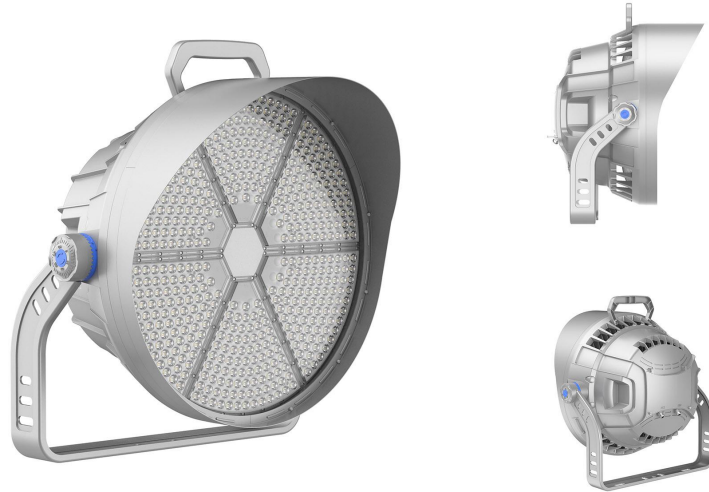

Product Specifications

(HELIOS LED HIGH MAST LIGHT)



The HELIOS LED High Mast Light is a robust round-shaped fixture designed for optimal performance and durability. Crafted with die-cast aluminum and high thermal conductivity, it ensures rapid heat dissipation and superior thermal management in a compact structure. Equipped with top-quality LEDs and reliable power supply, this light offers a 5-year warranty, demonstrating its commitment to longevity. It features an IP66 waterproof rating and double surge protection up to 10KV to withstand harsh conditions. The anti-UV optical lens boasts an IK08 rating and over 94% light transmittance, ensuring professional light distribution across various beam angles. Optional tempered glass cover and spill shield further enhance its functionality, minimizing light pollution and making it ideal for diverse applications.

Features

- Die-cast Aluminum heat sinking, high thermal conductivity enables rapid heat dissipation to the outside, excellent thermal management & compact structure;
- Packed with reputed brand LEDs and power supply to ensure the product reliability and life expectancy, 5 years warranty;
- IP66 structural waterproof design; Double surge protection: driver & extra 10KV SPD;
- Anti UV optical polycarbonate lens, IK08 and light transmittance > 94%, professional light distribution with different beam angles for various applications;
- Optional tempered glass cover, apply in harsh conditions;
- Spill shield to reduce light pollution.

Technical Specifications

Model No.	LGS-GSHL-400W	LGS-GSHL-500W	LGS-GSHL-600W	LGS-GSHL-800W	LGS-GSHL-1000W	LGS-GSHL-1200W
Power	400W	500W	600W	800W	1000W	1200W
Lumen Output	60,000lm	75,000lm	90,000lm	120,000lm	150,000lm	180,000lm
Lumen Efficiency	150lm/w					
CCT	3000/4000/5000/5700/6500K					
CRI	Ra>80(Ra>90 optional)					
Chip Brand	Lumileds/Osram					
Beam Angle $\theta/2$	10°/ 15°/ 25°/ 45°/ 60°/ 90°					
Light Decay Rate	Less than 3% in 6,000Hours					
Lifespan	≥50,000Hrs					
Input Voltage	100-240VAC 50/60Hz					
Power Factor	PF>0.95					
THD	<15%					
Driver Brand	Meanwell/Sosen/Inventronics					
Material	Die-cast Aluminum Housing+Polycarbonate Lens+Tempered Glass Cover(on request)					
Degree of Protection	IP66 IK08					
Dimensions	522*509*389mm			681*660*497mm		
Net Weight	17kg			30kg		
Package	1pcs/CTN					
Gross Weight	19KG			32kg		
Carton Dimensions	600*650*370mm			755*800*440mm		
Finish	Grey					
Installation	Mounting					
Working Temperature	-30°C~+50°C					
Storage Temperature	-40°C~+70°C					
Certificate	CE, RoHS					
Warranty	5 years					
Optional Functions	0-10V/PWM/DALI/DMX Available on Request					

Explosion Drawing

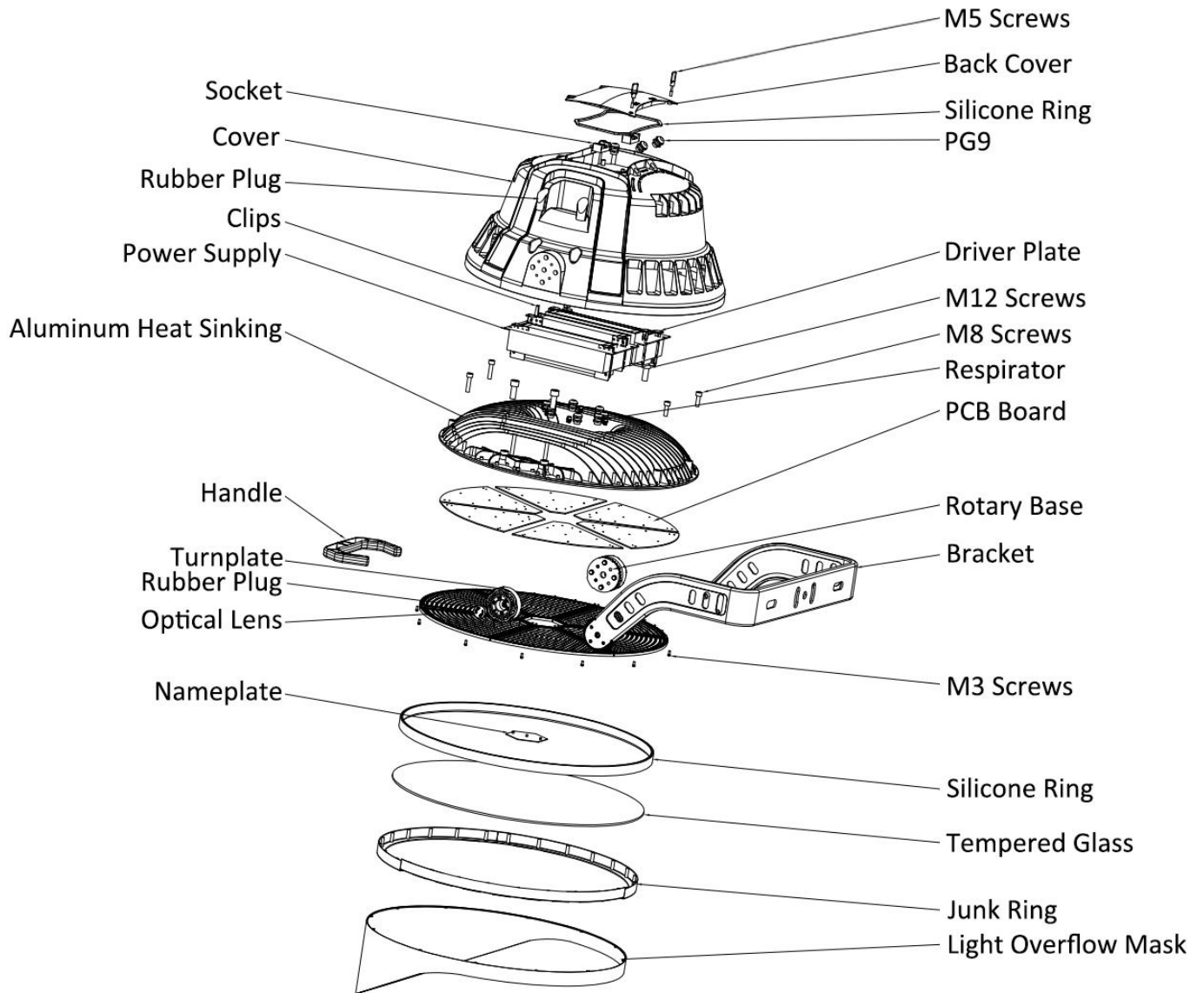

Light Distribution Curves

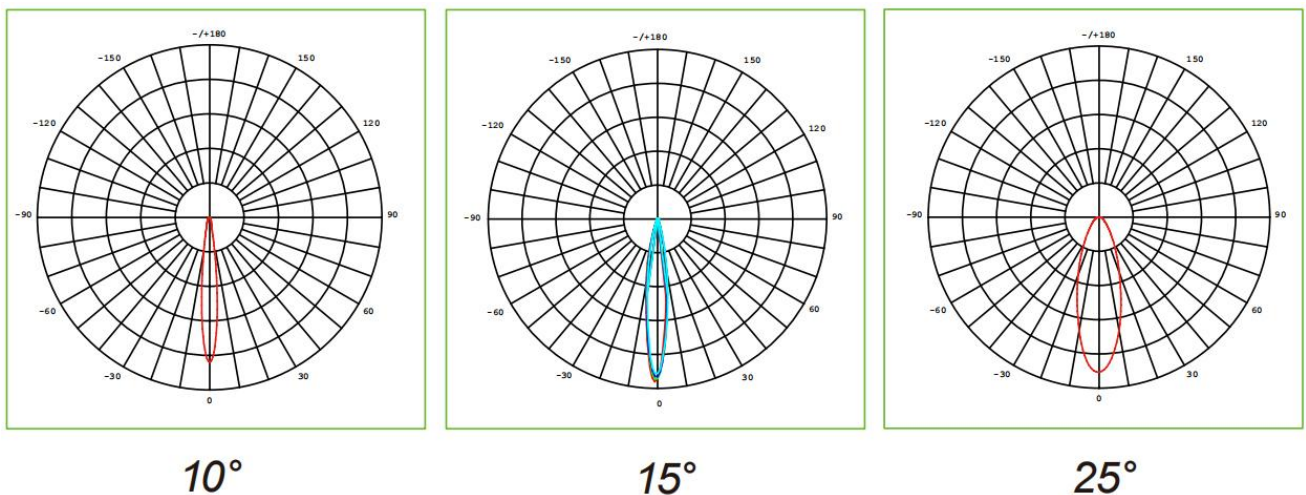

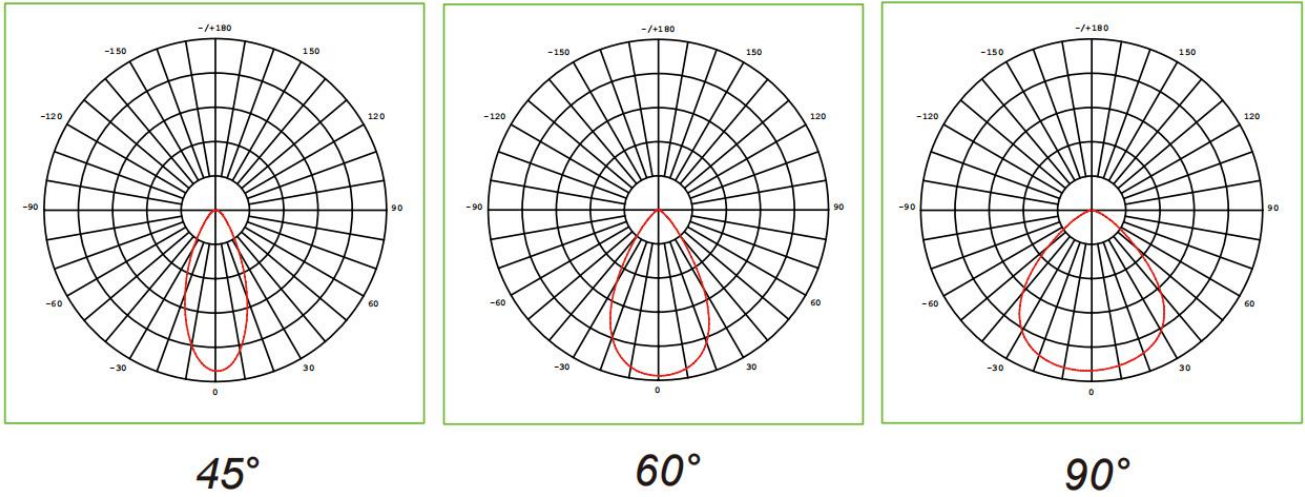

Dimensions and Drawings

Unit: mm

400/500/600W

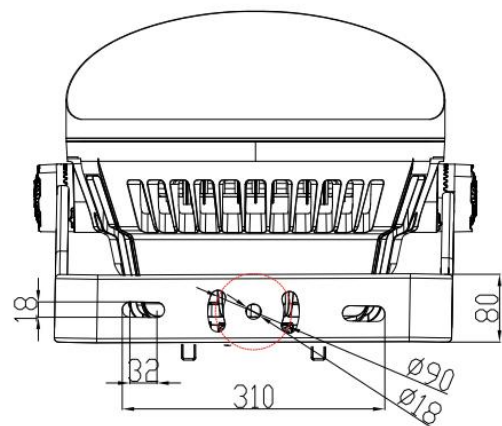
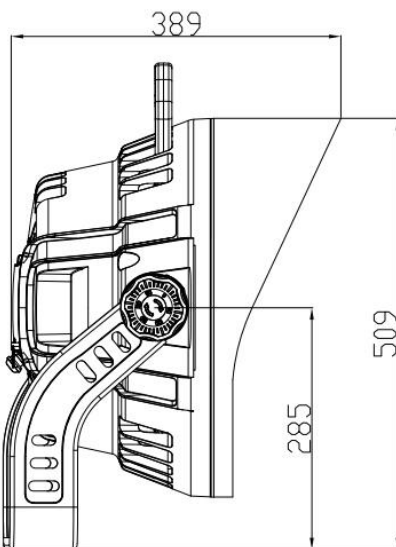
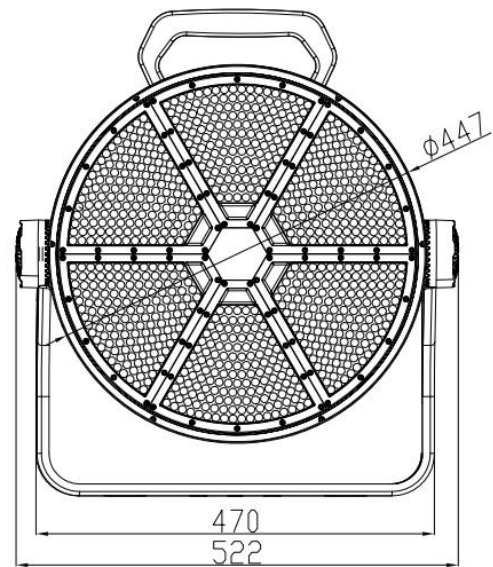
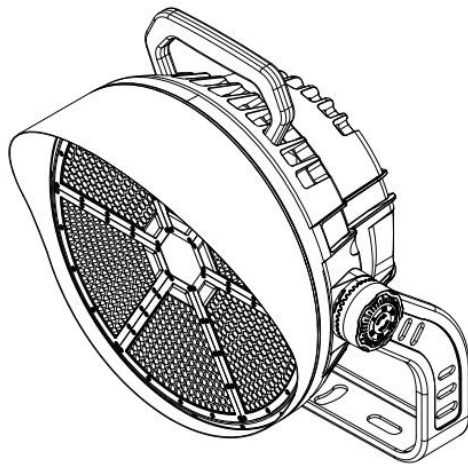

800/1000/1200W

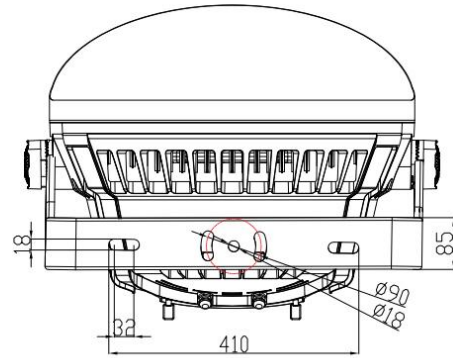
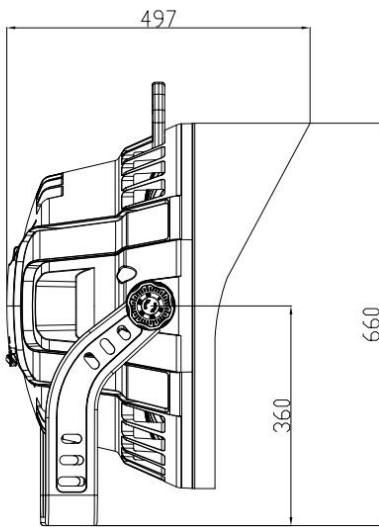
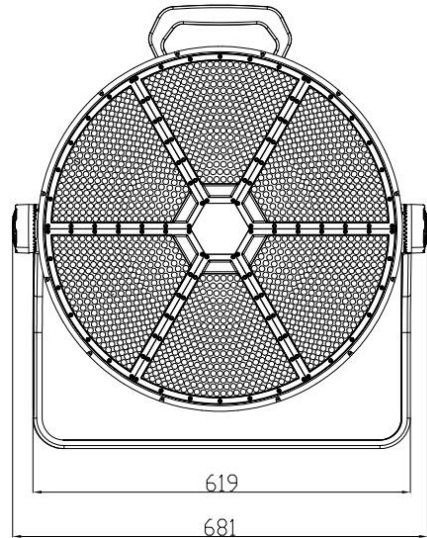
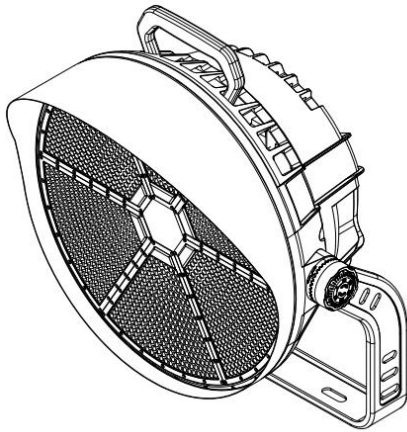

Installations

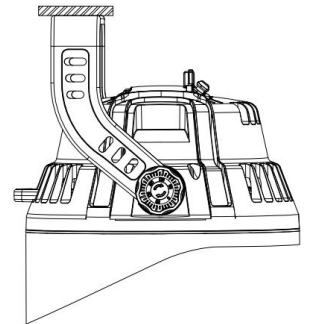
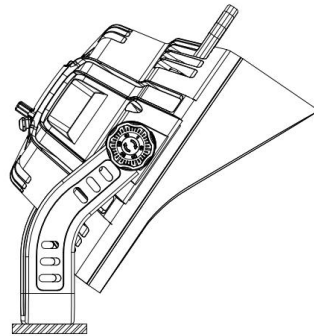
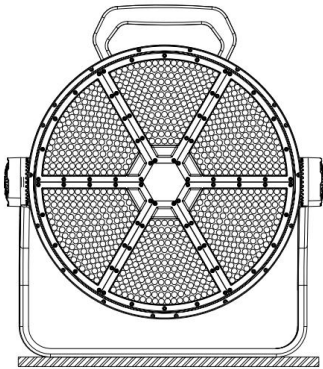

Installation Requirements

1. Power off before installation, and read the instruction carefully;
2. Make sure the installation material can endure the lamp weight;
3. Please prepare two sets of expansion bolts, and drill holes in the installation body, then install the lamp, finally screw down expansion bolts and bracket screws;
4. Connect lamp wire to match power wire, and seal the joint with insulation;
5. The lamp must be installed reliably to prevent loosening and falling off.

Notice

1. Please first read the product specification carefully, make sure the using environment conform to specification, then it can be used;
2. Please confirm the input voltage, frequency before use;
3. This product must be installed by professionals;
4. If there is any damage to the power wire or shell of the product, it should be taken as defective product and do not use it;
5. Dangerous high voltage, non-professionals are not allowed to maintain the product;
6. If external soft cable or soft wire of the light is damaged, it should be replaced by manufacturer or service agent or personnel with similar qualification to avoid danger.

Applications

