



# Product Specifications

## (LYRA LED VAPOR LIGHT)



The Lyra LED Vapor Light, engineered for durability and safety in challenging environments. Its robust polycarbonate body and diffuser boast high impact resistance (IK10) and UV protection, encapsulating an aluminum heat sink that ensures optimal heat dissipation. This vapor light is designed with a dust and waterproof structure rated IP65, making it ideal for areas requiring robust lighting solutions. The isolated PC body enhances electrical safety, while the flicker-free illumination and uniform light provides for excellent visibility. Optional installation with surface mounted or suspension, the Lyra LED Vapor Light is an ideal replacement for existing fixtures or new installation, offering a long lifespan of over 50,000 hours backed by a 5-year warranty.

## Features

- Polycarbonate body and diffuser, high impact resistance IK10, UV resistance;
- Aluminum heat sinking inside the integrated body to make sure excellent heat dissipation;
- Isolated strong PC body, completely comply with electricity safety;
- Adopt dust and waterproof structure design, protection level IP65;
- Flicker free, uniform light spots;
- Fast and easy installation to replace existing lighting fixtures;
- Long lifetime over 50,000 hours, 5 years warranty.

# Technical Specifications

<b>Model No.</b>	LGS-TPLLR-06-20W	LGS-TPLLR-12-30W	LGS-TPLLR-12-40W	LGS-TPLLR-15-50W	LGS-TPLLR-15-60W
<b>Power</b>	20W	30W	40W	50W	60W
<b>Dimensions</b>	L600*W124*H43mm	L1200*W124*H43mm		L1500*W124*H43mm	
<b>Lumen Output</b>	WW 2500lm	WW 3700lm	WW 5000lm	WW 6300lm	WW 7600lm
	NW 2550lm	NW 3850lm	NW 5150lm	NW 6450lm	NW 7750lm
	CW 2600lm	CW 3900lm	CW 5200lm	CW 6500lm	CW 7800lm
<b>Lumen Efficiency</b>	130lm/w				
<b>CCT</b>	3000/4000/5000/5700/6500K				
<b>CRI</b>	Ra>80(Ra>90 on request)				
<b>LED Type</b>	SMD2835				
<b>Beam Angle</b>	120 degree				
<b>Light Decay Rate</b>	Less than 3% in 6,000Hours				
<b>Lifespan</b>	≥50,000Hrs				
<b>Input Voltage</b>	100-240VAC 50/60Hz				
<b>Power Factor</b>	PF>0.95				
<b>THD</b>	<15%				
<b>Material</b>	Polycarbonate housing+Polycarbonate diffuser+Aluminum heat sinking				
<b>Degree of Protection</b>	IP65				
<b>Appearance</b>	White/Black				
<b>Package</b>	8pcs/Carton				
<b>Carton Size(mm)</b>	645x275x235	1245x275x235		1545x275x235	
<b>Carton G.W.</b>	8.70 Kg	14.60 Kg		17.80 Kg	
<b>Installation</b>	Mounted/Suspended				
<b>Working Temperature</b>	-30°C~+50°C				
<b>Storage Temperature</b>	-40°C~+70°C				
<b>Certificate</b>	CE, RoHS				
<b>Warranty</b>	5 years				
<b>Optional Functions</b>	Dimming/Emergency/Motion Sensor on Request				

# Pictures



IP65 IK10

NON FLICKER  
FLICKER FREE



## Optional Functions

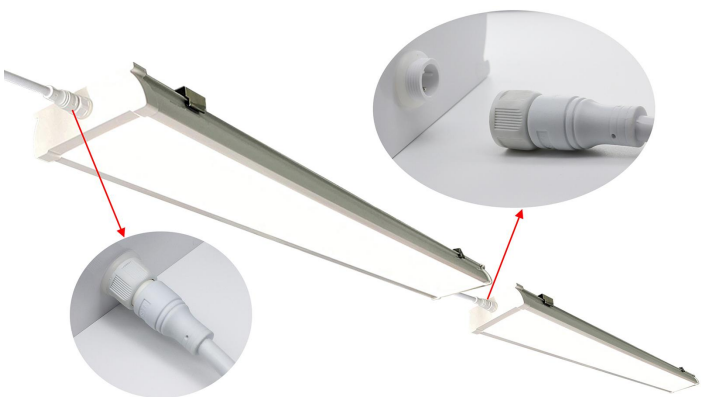

Linkable with Plug & Play Cable Connector

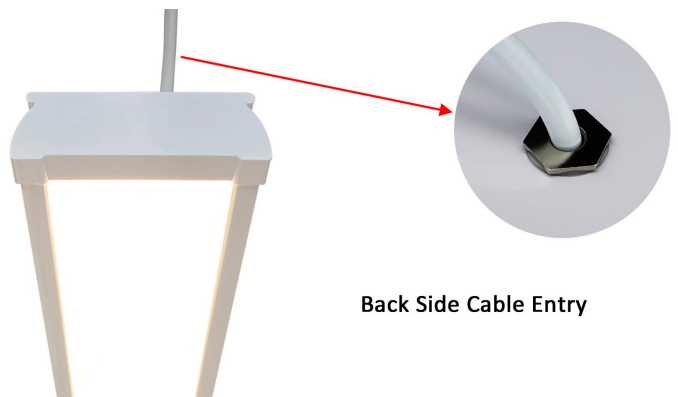

Back Side Cable Entry

# Installations

## Ceiling mounted

1. Drill 8mm cutting holes, put plastic plug and lock the clips on the ceiling with self-taping screws.

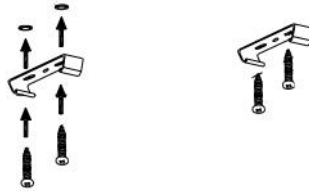
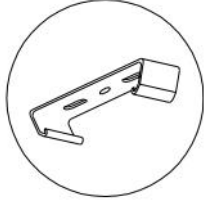

2. Put the lamp into the clips properly.

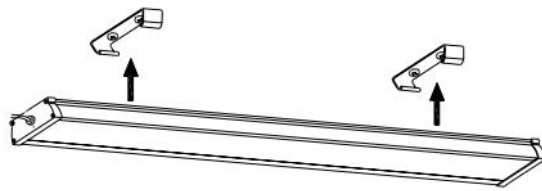

3. Connect to the power with AC85-265V.



## Suspended

1. Drill 8mm cutting holes, put plastic plug and lock the clips on the ceiling with self-taping screws.

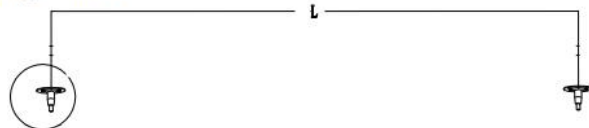

2. Hang the lamp with lifting role and clip and then connect to the power with AC 85-265V.

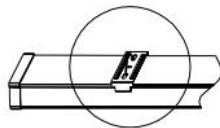

## Installation Requirements

1. Power off before installation, and read the instruction carefully;
2. Make sure the installation material can endure the lamp weight;
3. Connect lamp wire to match power wire, and seal the joint with insulation;
4. No matter which kind of installation method, the lamp must be installed reliably to prevent loosening and falling off.

## Notice

1. Please first read the product specification carefully, make sure the using environment conform to specification, then it can be used;
2. Please confirm the input voltage, frequency before use;
3. This product must be installed by professionals;
4. If there is any damage to the power wire or shell of the product, it should be taken as defective product and do not use;
5. Dangerous high voltage, non-professionals are not allowed to maintain the product;
6. If external soft cable or soft wire of the light is damaged, it should be replaced by manufacturer or service agent or personnel with similar qualification to avoid danger.

## Applications

LED vapor lights are mostly used to public lighting, commercial lighting and industrial lighting applications:

- Underfloor cars parking lot
- Supermarkets, shops, hotels
- Stockrooms, warehouses, workshops
- Food processing, food storage, clean room
- Airport/Train/Bus station waiting rooms, etc

