



Product Specifications

(EOS LED VAPOR LIGHT)



WW NW CW



The Eos LED Vapor Light is a high-performance lighting solution designed for durability and efficiency. Featuring a robust high impact & UV resistance polycarbonate body and diffuser, it is built to withstand harsh environments. Its dust and waterproof design with an IP65 rating ensures reliability in industrial and commercial applications. The Eos vapor light is packed with branded LEDs and a reliable power supply for long-lasting performance, exceeding 50,000 hours, and comes with a five-year warranty. It offers fast and easy installation, making it an ideal replacement for existing fixtures. With selectable CCT options—Warm White, Natural White, and Cool White—the Eos LED Vapor Light provides versatile lighting solutions to meet diverse needs.

Features

- Polycarbonate body and diffuser, aluminum heat sinking inside, high impact resistance, UV resistance;
- Adopt dust and waterproof structure design, protection level IP65;
- Use branded LEDs and power supply, to ensure the product reliability and life expectancy;
- Fast and easy installation to replace existing lighting fixtures;
- Available with CCT selectable Warm White, Natural White and Cool White;
- Long lifetime over 50,000 hours, 5 years warranty.

Technical Specifications

Model No.	LGS-TPLES-06-18W	LGS-TPLES-09-24W	LGS-TPLES-12-36W	LGS-TPLES-15-48W
Power	18W	24W	36W	48W
Lumen Output	2340lm	3120lm	4680lm	6240lm
Lumen Efficiency	130lm/w			
CCT	2700/3000/4000/5000/5700/6500K(3000/4000/5000K CCT Selectable on request)			
CRI	Ra>80(Ra>90 optional)			
Light Decay Rate	Less than 3% in 6,000Hours			
Lifespan	≥50,000Hrs			
Input Voltage	220-240Vac/100-277Vac 50/60Hz			
Power Factor	PF>0.9			
THD	<15%			
Driver Brand	Philips/Osram/KGP/ZY			
Material	Polycarbonate housing+Polycarbonate diffuser+Aluminum heat sinking			
Degree of Protection	IP65			
Dimensions	L600*W51*H53mm	L900*W51*H53mm	L1200*W51*H53mm	L1500*W51*H53mm
Appearance	White			
Installation	Mounted/Suspended			
Working Temperature	-30℃~+50℃			
Storage Temperature	-40℃~+70℃			
Certificate	CE, RoHS			
Warranty	5 years			
Optional Functions	Dimming on Request			

Dimensions and Drawings

Unit: mm

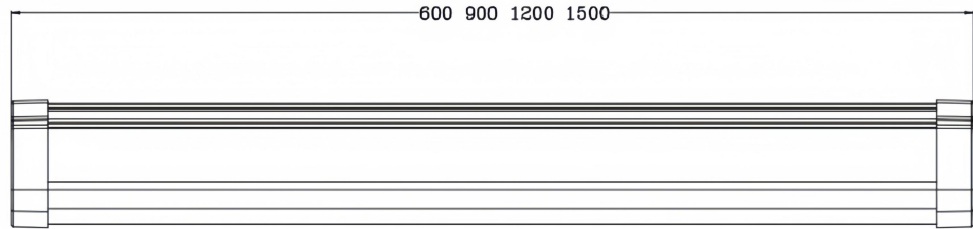
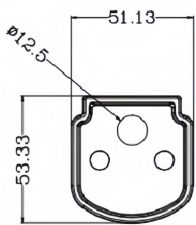

Installations

Surface Mounted



Suspended

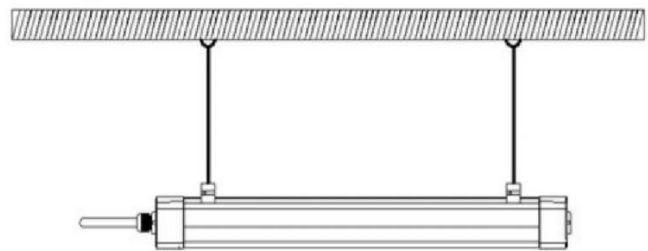

Ceiling Mounted Bracket



Suspension Wire Kits

Installation accessories
SUS304 Stainless Steel

Wiring Diagram

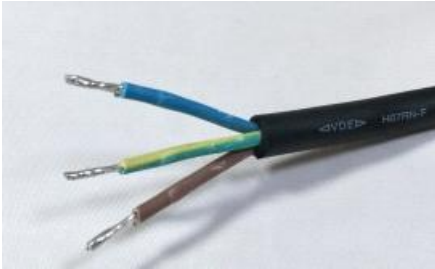

VDE Approval rubber cable

Item code	3 core cables
L	Brown
N	Blue
GND	Yellow/Green

Package

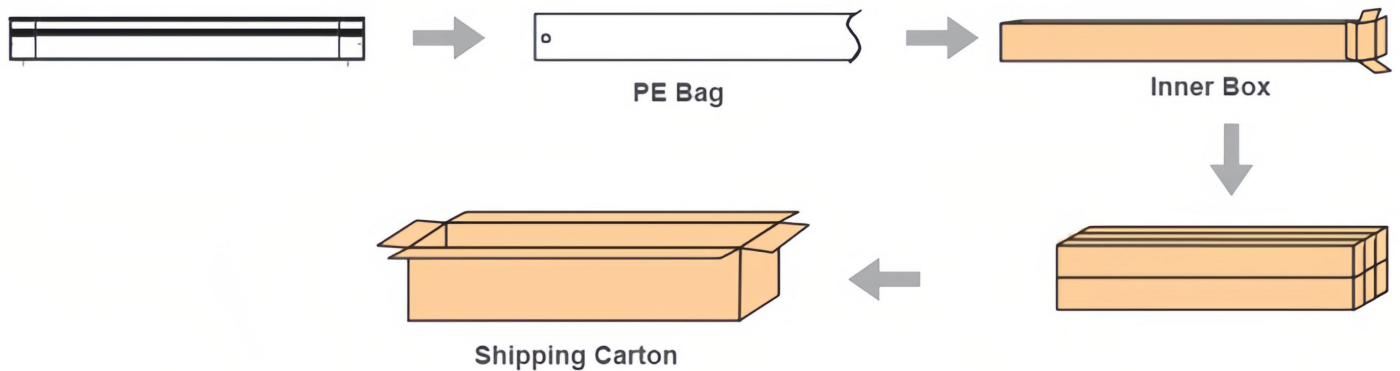

Installation Requirements

1. Power off before installation, and read the instruction carefully;
2. Make sure the installation material can endure the lamp weight;
3. Connect lamp wire to match power wire, and seal the joint with insulation;
4. No matter which kind of installation method, the lamp must be installed reliably to prevent loosening and falling off.

Notice

1. Please first read the product specification carefully, make sure the using environment conform to specification, then it can be used;
2. Please confirm the input voltage, frequency before use;
3. This product must be installed by professionals;
4. If there is any damage to the power wire or shell of the product, it should be taken as defective product and do not use;
5. Dangerous high voltage, non-professionals are not allowed to maintain the product;
6. If external soft cable or soft wire of the light is damaged, it should be replaced by manufacturer or service agent or personnel with similar qualification to avoid danger.

Applications

LED vapor lights are mostly used to public lighting, commercial lighting and industrial lighting applications:

- Underfloor cars parking lot
- Supermarkets, shops, hotels
- Stockrooms, warehouses, workshops
- Airport/Train/Bus station waiting rooms, etc

